

# Getting Started

## Trouble Shooting Guide

### User Manual

Read in conjunction with  
Kwiktech Build Guide

Designed by

**kwiktech.**

Rev 0

This Manual is the sole property of  
Kwiktech Pty Ltd.  
All rights are reserved.

This Manual is designed to be only  
used with Kwiktech  
produced products.

No part of this Manual or the  
Kwiktech product design may be  
copied or reproduced without the  
consent of Kwiktech Pty Ltd.

Construction using Kwiktech  
products may require planning  
approval. Always contact your Local  
Council for the most up-to-date  
rules and regulations for your area.

All dimensions are in millimeters  
(mm)

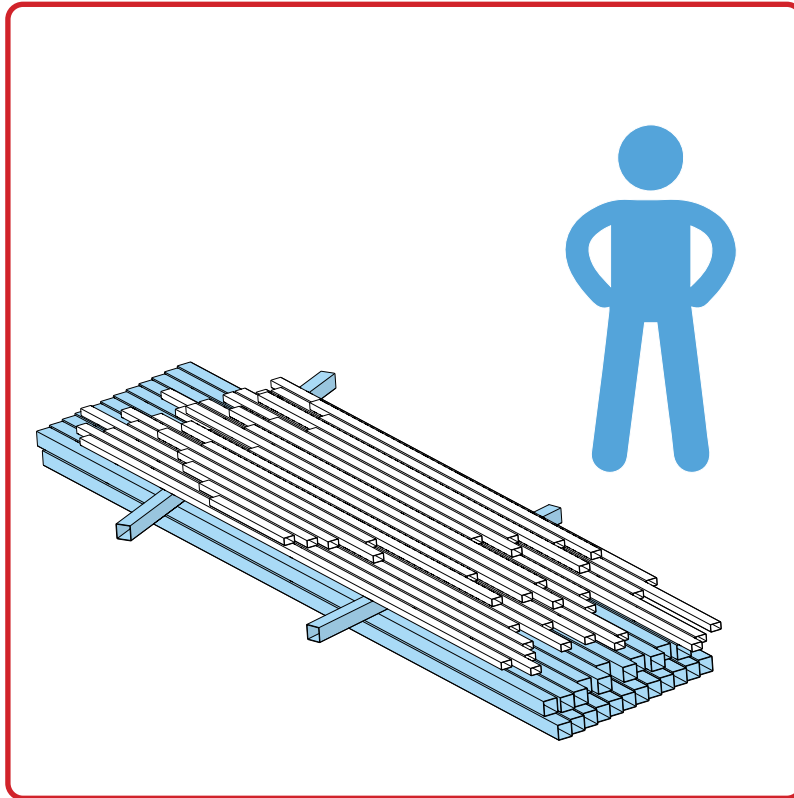

**Issue:** Determining steel members

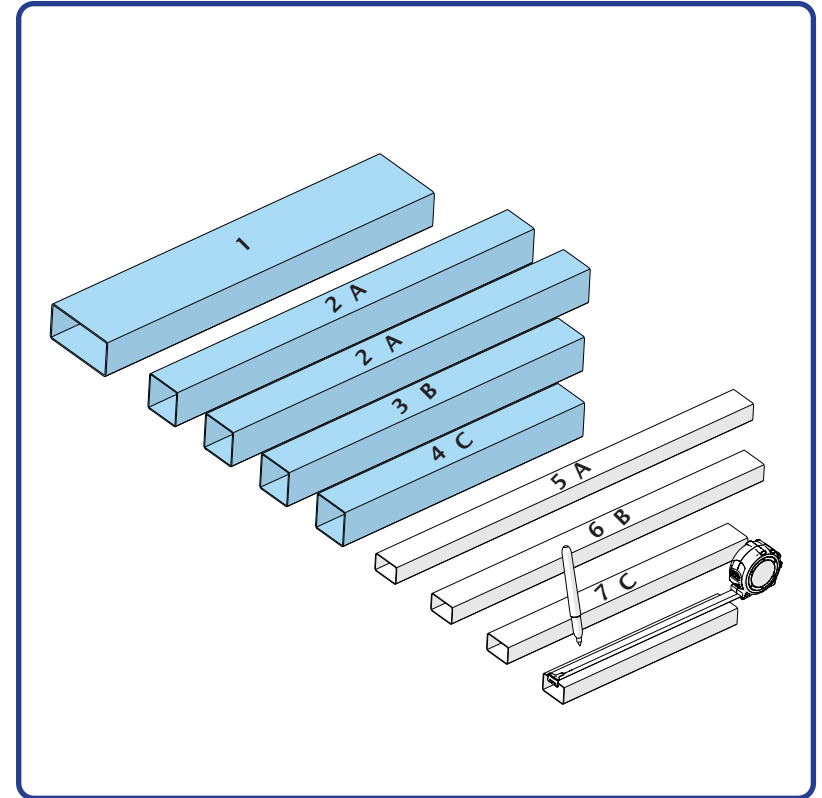

**Solution:** With a tape measure and marker pen  
determine each material type and length and write  
on each member its manual related Item ID &  
Assembly ID from the material list. This will make  
the assembly process very easy.

# Deformed & Burred RHS

## Trouble Shooting Guide

User Manual

Read in conjunction with  
Kwiktech Build Guide

Designed by

**kwiktech.**

Rev 0

This Manual is the sole property of  
Kwiktech Pty Ltd.  
All rights are reserved.

This Manual is designed to be only  
used with Kwiktech  
produced products.

No part of this Manual or the  
Kwiktech product design may be  
copied or reproduced without the  
consent of Kwiktech Pty Ltd.

Construction using Kwiktech  
products may require planning  
approval. Always contact your Local  
Council for the most up-to-date  
rules and regulations for your area.

All dimensions are in millimeters  
(mm)

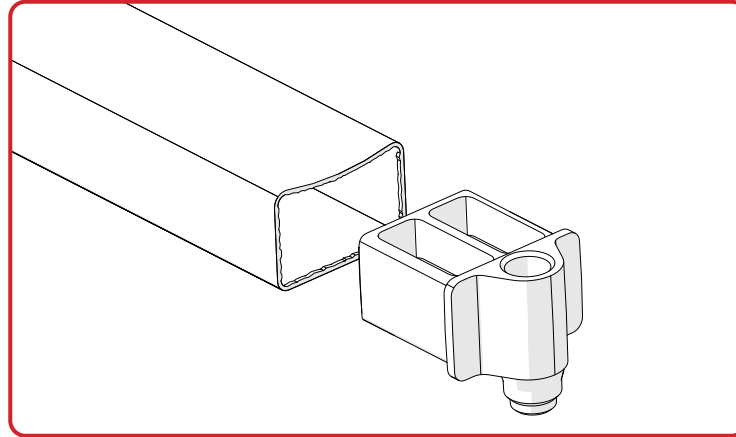

**Issue:** Deformed and burred 38X25 rail sections due to cutting process and can't insert Rail Inserts properly.

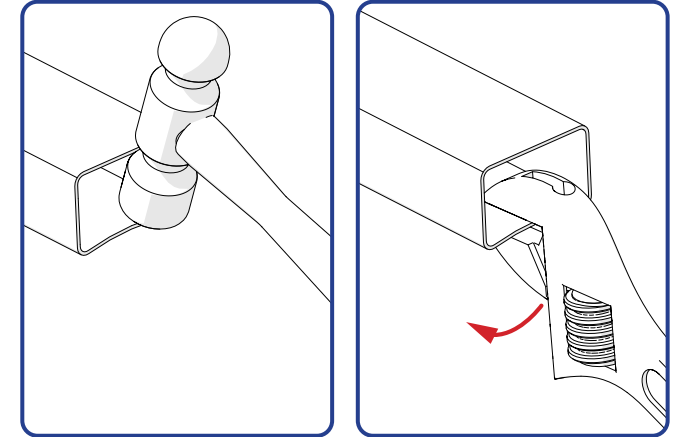

**Solution:** Hit deformed ends straight with small ball-peen hammer or fold out with adjustable spanner or wrench closed near tight and lever straight.

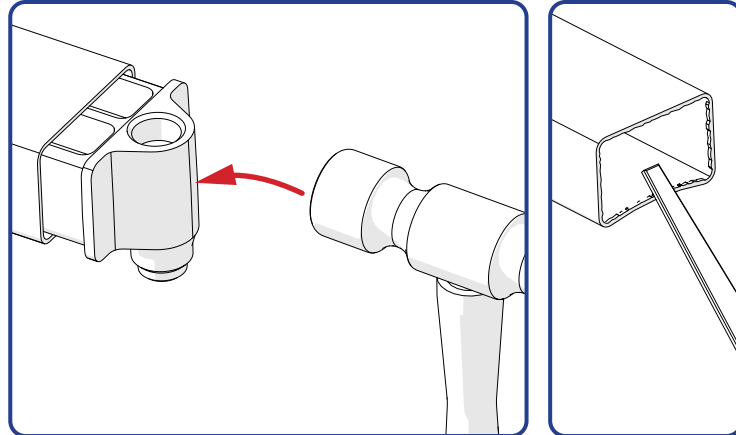

**Solution:** Light taps on the Rail mid front will help push through internal burr obstructions and mild deformed rail ends. Shaving off Rail Inserts external walls is normal. For 1.6mm thick walled RHS, a file will be needed to remove internal wall burrs.

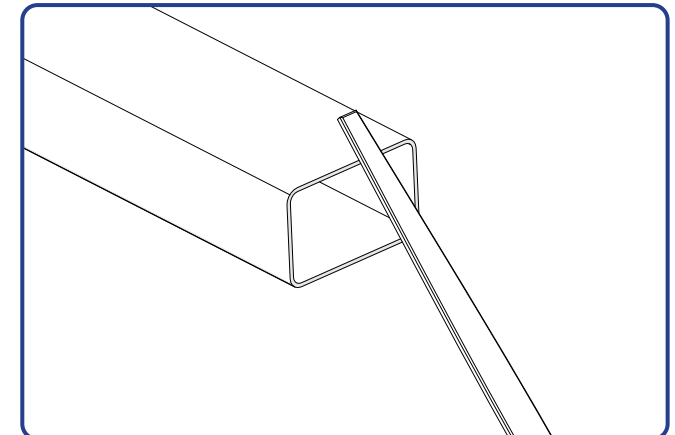

**Solution:** If desired external burrs can be removed with metal file or mechanical methods such as a sanding disk.

# Extra Strong Rail Not Fitting Flat

## Trouble Shooting Guide

User Manual

Read in conjunction with  
Kwiktech Build Guide

Designed by

**kwiktech.**

Rev 0

This Manual is the sole property of  
Kwiktech Pty Ltd.  
All rights are reserved.

This Manual is designed to be only  
used with Kwiktech  
produced products.

No part of this Manual or the  
Kwiktech product design may be  
copied or reproduced without the  
consent of Kwiktech Pty Ltd.

Construction using Kwiktech  
products may require planning  
approval. Always contact your Local  
Council for the most up-to-date  
rules and regulations for your area.

All dimensions are in millimeters  
(mm)

[www.kwiktech.com.au](http://www.kwiktech.com.au)  
© Kwiktech Pty Ltd 2020

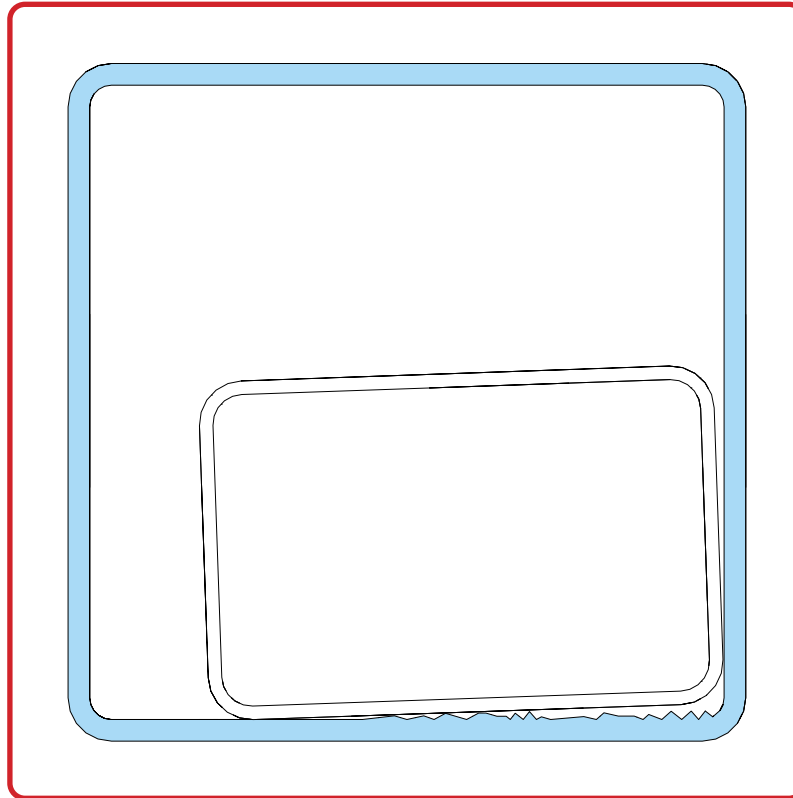

**Issue:** 50x50 SHS ends have burrs or bends which stop the 38x25 RHS from sitting flat internally.

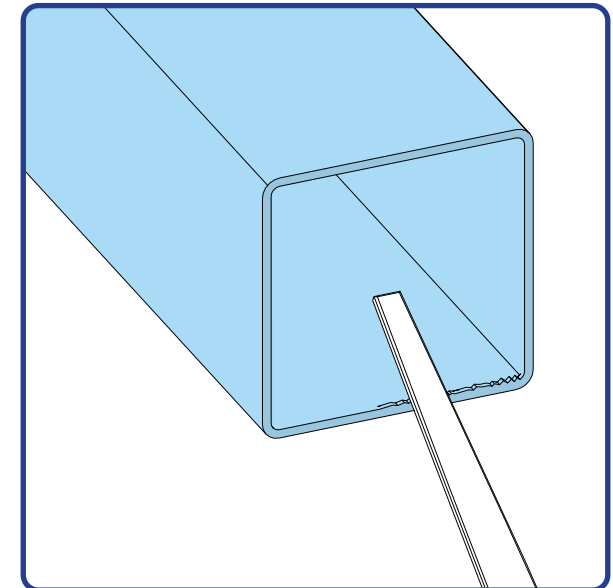

**Solution:** Remove burrs with a file or with mechanical methods.

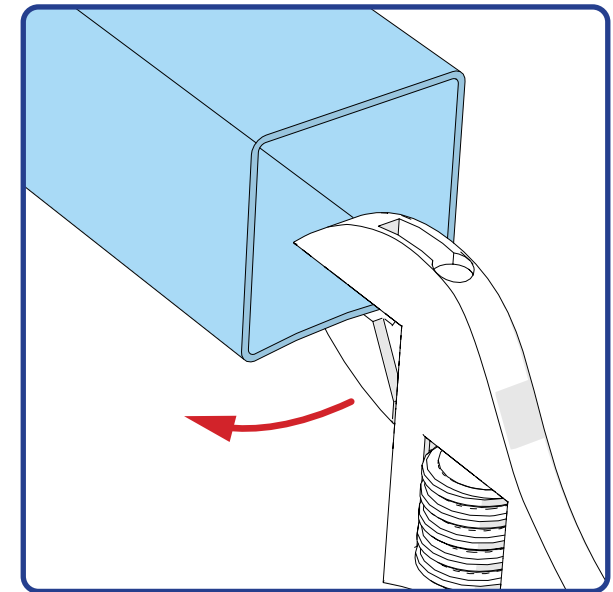

**Solution:** Hit deformed ends straight with small ball-peen hammer or fold out with adjustable spanner or wrench closed near tight and lever straight.

# Broken Self Drilling Screws

## Trouble Shooting Guide

*User Manual*

Read in conjunction with  
Kwiktech Build Guide

Designed by

**kwiktech.**

Rev 0

This Manual is the sole property of  
Kwiktech Pty Ltd.  
All rights are reserved.

This Manual is designed to be only  
used with Kwiktech  
produced products.

No part of this Manual or the  
Kwiktech product design may be  
copied or reproduced without the  
consent of Kwiktech Pty Ltd.

Construction using Kwiktech  
products may require planning  
approval. Always contact your Local  
Council for the most up-to-date  
rules and regulations for your area.

All dimensions are in millimeters  
(mm)

[www.kwiktech.com.au](http://www.kwiktech.com.au)  
© Kwiktech Pty Ltd 2020

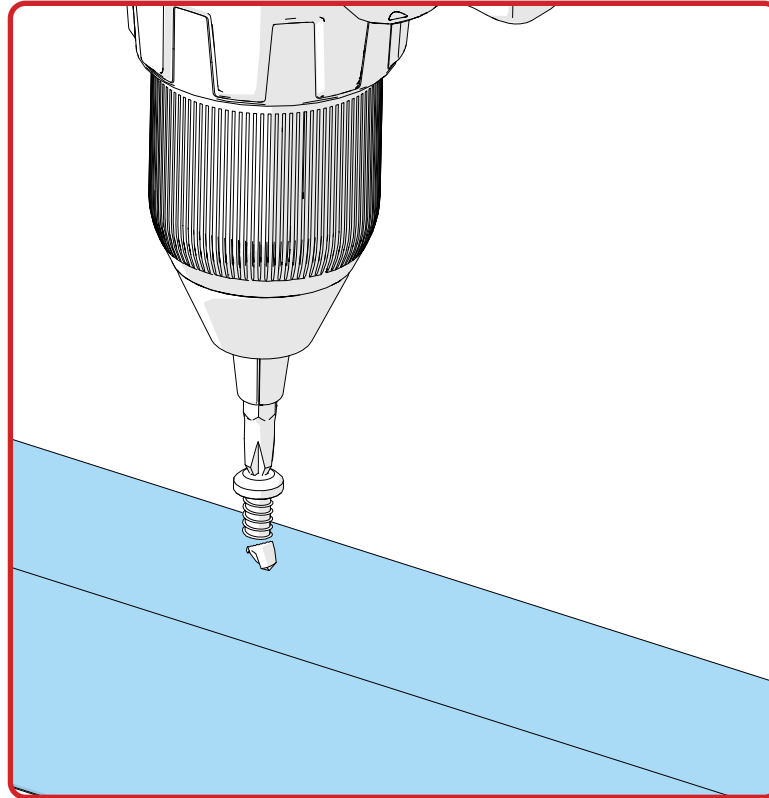

**Issue:** Self-Drilling screws breaking at their tips when drilling.

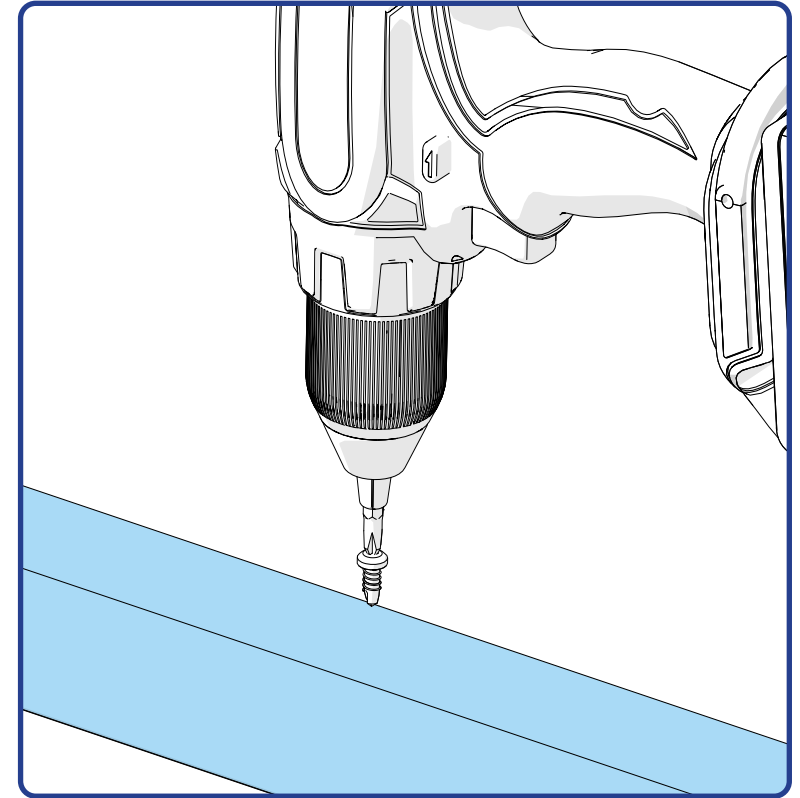

**Solution:** Apply less downwards force when drilling, drill rotation faster & let the screw do the work.

# Self Drilling Screws not Engaging

## Trouble Shooting Guide

User Manual

Read in conjunction with  
Kwiktech Build Guide

Designed by

**kwiktech.**

Rev 0

This Manual is the sole property of  
Kwiktech Pty Ltd.  
All rights are reserved.

This Manual is designed to be only  
used with Kwiktech  
produced products.

No part of this Manual or the  
Kwiktech product design may be  
copied or reproduced without the  
consent of Kwiktech Pty Ltd.

Construction using Kwiktech  
products may require planning  
approval. Always contact your Local  
Council for the most up-to-date  
rules and regulations for your area.

All dimensions are in millimeters  
(mm)

[www.kwiktech.com.au](http://www.kwiktech.com.au)  
© Kwiktech Pty Ltd 2020

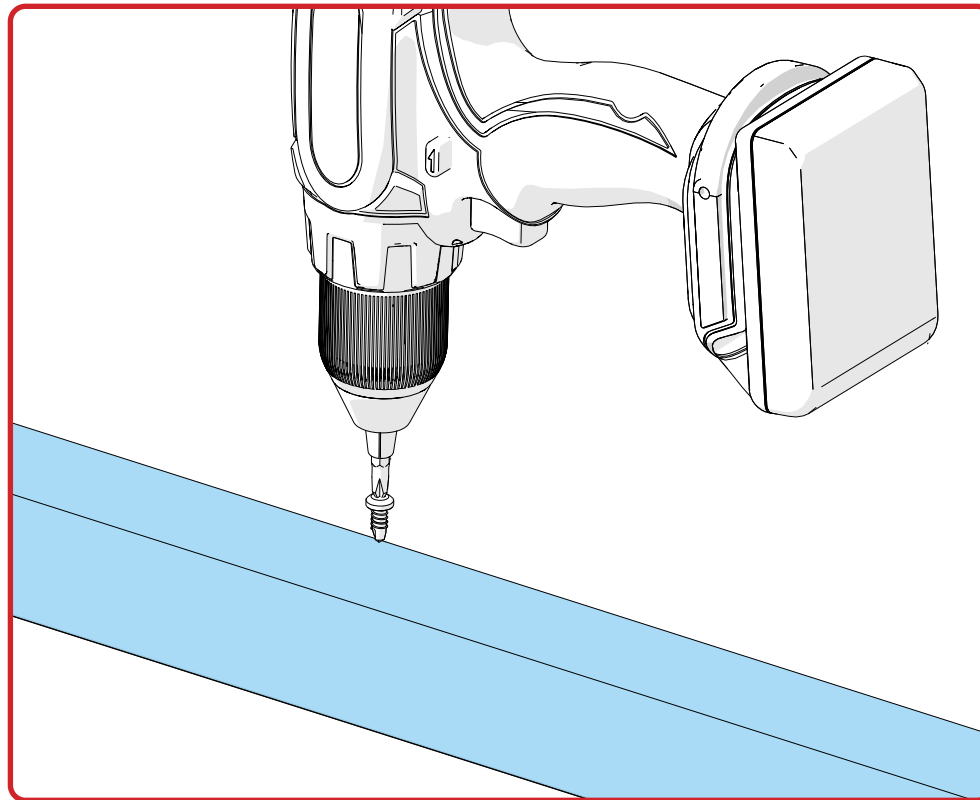

**Issue:** Drive ends of Self-Drilling screws not engaging properly

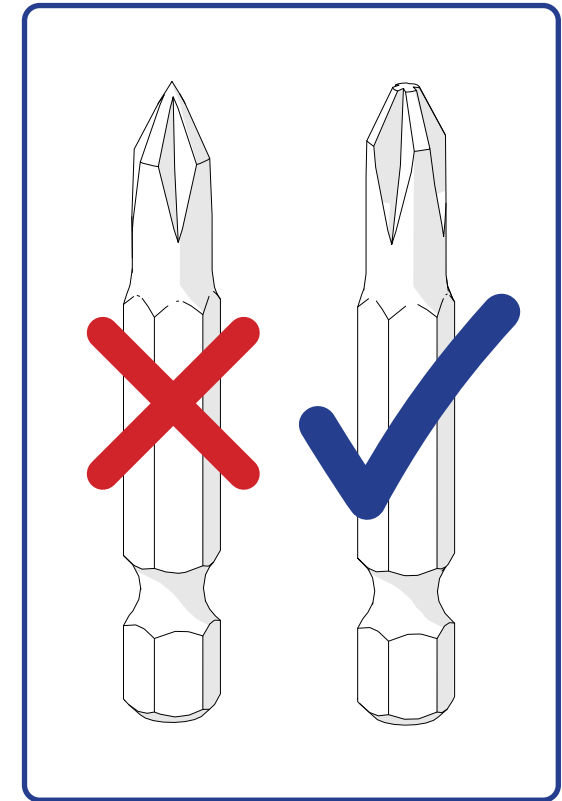

**Solution:** Ensure that the correct drill  
bit is being used. The number 2  
Phillips Head Bit may need replacing.

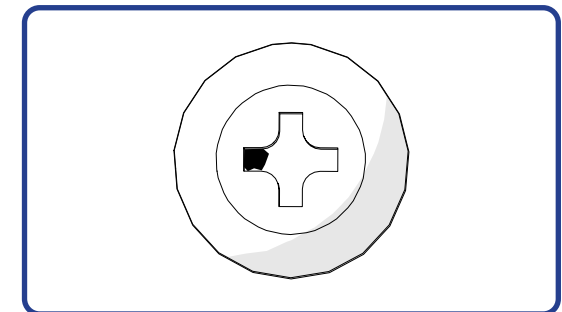

**Solution:** Check for debris or foreign  
objects stuck in the engaging section  
of the Self-Drilling screw.

# Rail Insert Upside-down

## Trouble Shooting Guide

User Manual

Read in conjunction with  
Kwiktech Build Guide

Designed by

**kwiktech.**

Rev 0

This Manual is the sole property of  
Kwiktech Pty Ltd.  
All rights are reserved.

This Manual is designed to be only  
used with Kwiktech  
produced products.

No part of this Manual or the  
Kwiktech product design may be  
copied or reproduced without the  
consent of Kwiktech Pty Ltd.

Construction using Kwiktech  
products may require planning  
approval. Always contact your Local  
Council for the most up-to-date  
rules and regulations for your area.

All dimensions are in millimeters  
(mm)

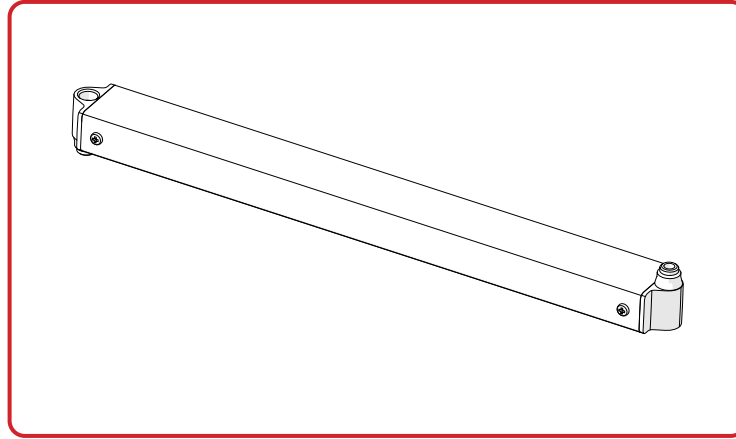

**Issue:** Rail Insert fixed upside-down.

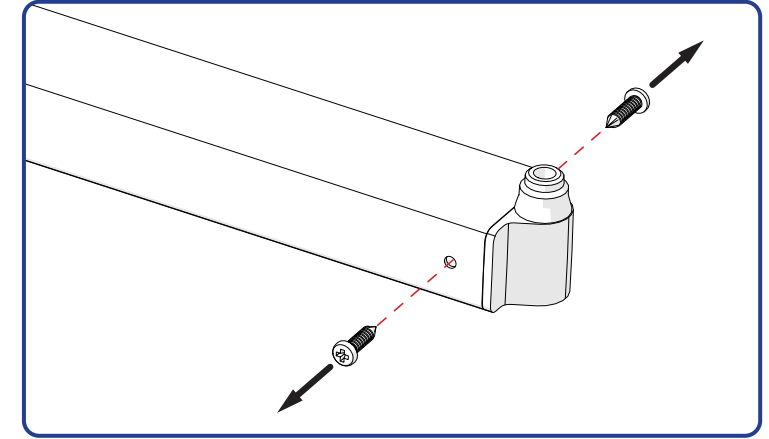

**Solution:** Remove self-Drilling screws

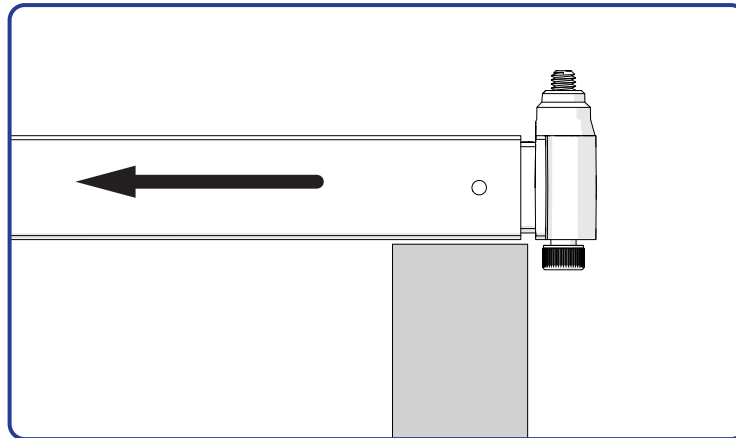

**Solution:** Place Cap Head bolt into Rail Insert and ensure the head of the bolt is protruding out. Hit the head of the cap head screw against a solid flat object while holding the rail until the Rail Connector is free from the rail.

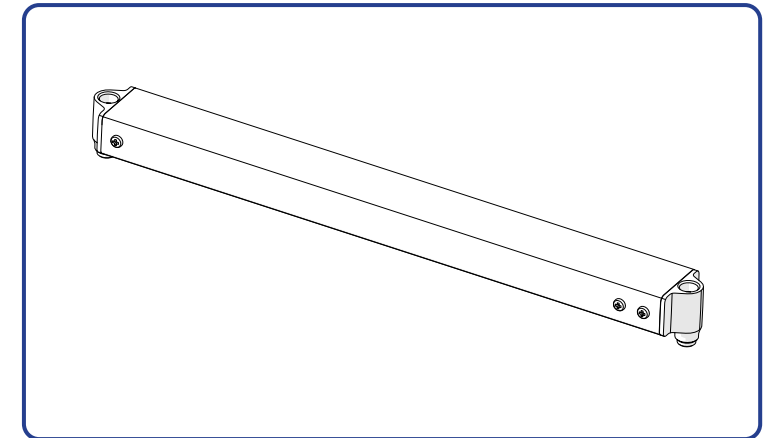

If using the same Rail Connector again fix extra screws each side of Rail Connector.

# Displacement Plate Forgotten or Universal Upside-down

## Trouble Shooting Guide

User Manual

Read in conjunction with  
Kwiktech Build Guide

Designed by

**kwiktech.**

Rev 0

This Manual is the sole property of  
Kwiktech Pty Ltd.  
All rights are reserved.

This Manual is designed to be only  
used with Kwiktech  
produced products.

No part of this Manual or the  
Kwiktech product design may be  
copied or reproduced without the  
consent of Kwiktech Pty Ltd.

Construction using Kwiktech  
products may require planning  
approval. Always contact your Local  
Council for the most up-to-date  
rules and regulations for your area.

All dimensions are in millimeters  
(mm)

[www.kwiktech.com.au](http://www.kwiktech.com.au)  
© Kwiktech Pty Ltd 2020

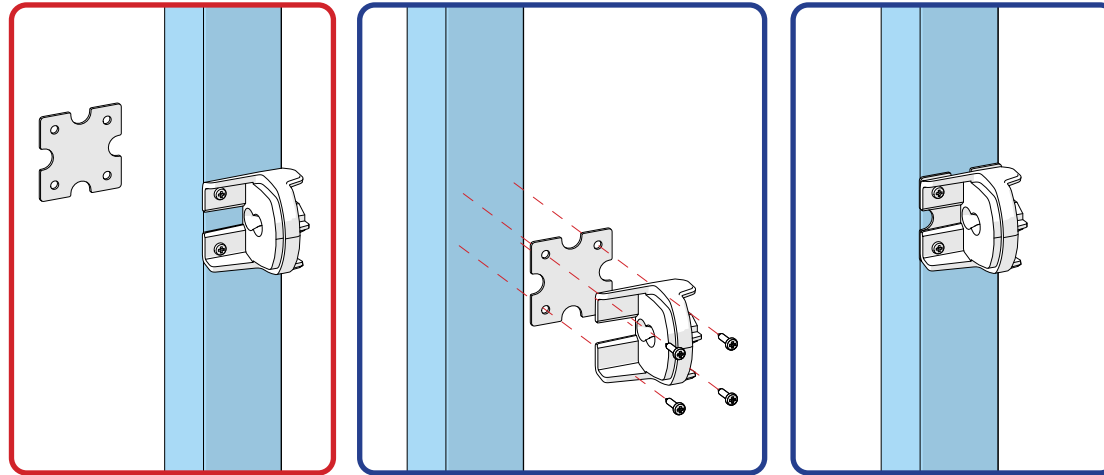

**Issue:** Forgot to add a Displacement Plate

**Solution:** Unscrew, fit as required and use new screws.  
Disregard previously used self-drilling screws. Mark datum lines  
where displacement plates are required to eliminate missing  
displacement plates.

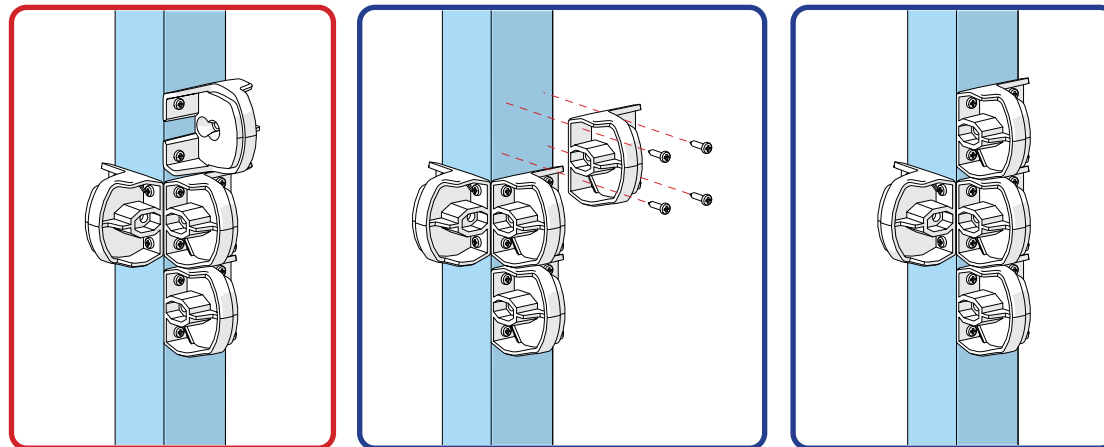

**Issue:** The Universal installed incorrect orientation.

**Solution:** Unscrew, rotate as required and use new screws.  
Disregard previously used self-drilling screws.

# Universal & Rail Measurements

## Trouble Shooting Guide

### User Manual

Read in conjunction with  
Kwiktech Build Guide

Designed by

**kwiktech.**

Rev 0

This Manual is the sole property of  
Kwiktech Pty Ltd.  
All rights are reserved.

This Manual is designed to be only  
used with Kwiktech  
produced products.

No part of this Manual or the  
Kwiktech product design may be  
copied or reproduced without the  
consent of Kwiktech Pty Ltd.

Construction using Kwiktech  
products may require planning  
approval. Always contact your Local  
Council for the most up-to-date  
rules and regulations for your area.

All dimensions are in millimeters  
(mm)

[www.kwiktech.com.au](http://www.kwiktech.com.au)  
© Kwiktech Pty Ltd 2020

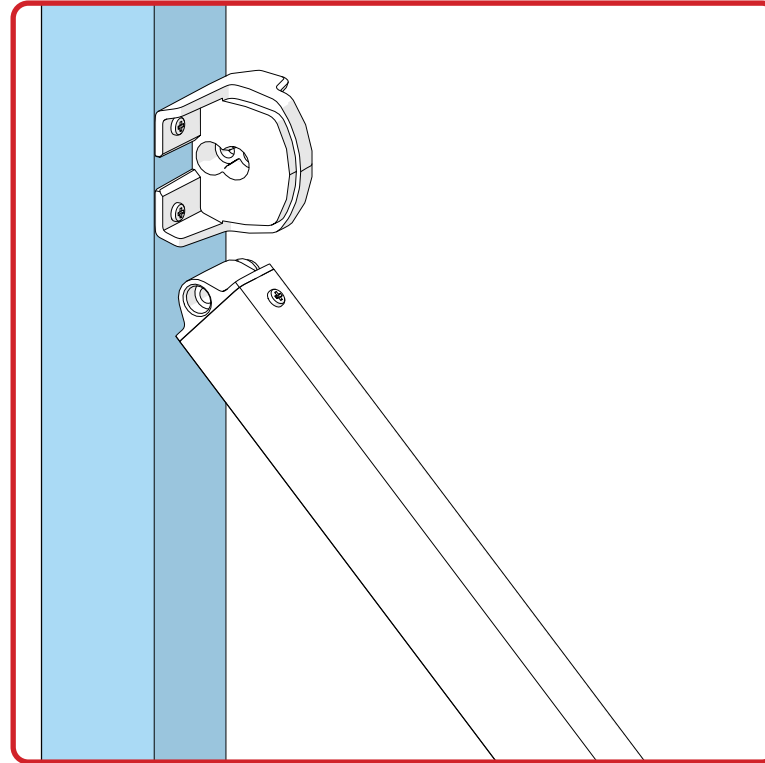

**Issue:** Universal Connector in the wrong position or rail member is too long/short from DIY cutting.

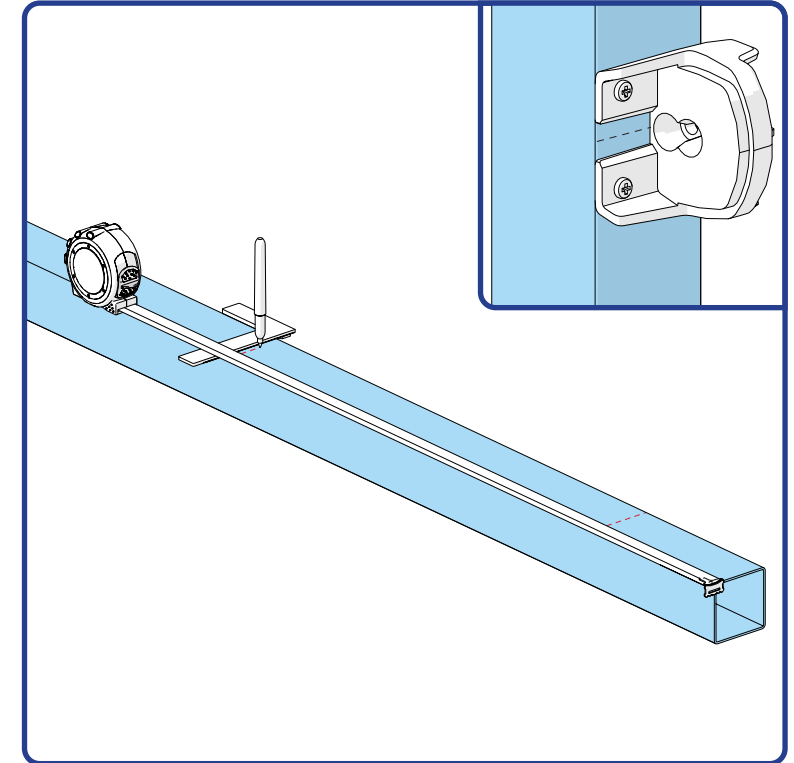

**Solution:** Use a square to draw straight center lines. Measure twice before fixing Universal connectors or cutting rail members lengths.



# Clashing Screws

## Trouble Shooting Guide

User Manual

Read in conjunction with  
Kwiktech Build Guide

Designed by

**kwiktech.**

Rev 0

This Manual is the sole property of  
Kwiktech Pty Ltd.  
All rights are reserved.

This Manual is designed to be only  
used with Kwiktech  
produced products.

No part of this Manual or the  
Kwiktech product design may be  
copied or reproduced without the  
consent of Kwiktech Pty Ltd.

Construction using Kwiktech  
products may require planning  
approval. Always contact your Local  
Council for the most up-to-date  
rules and regulations for your area.

All dimensions are in millimeters  
(mm)

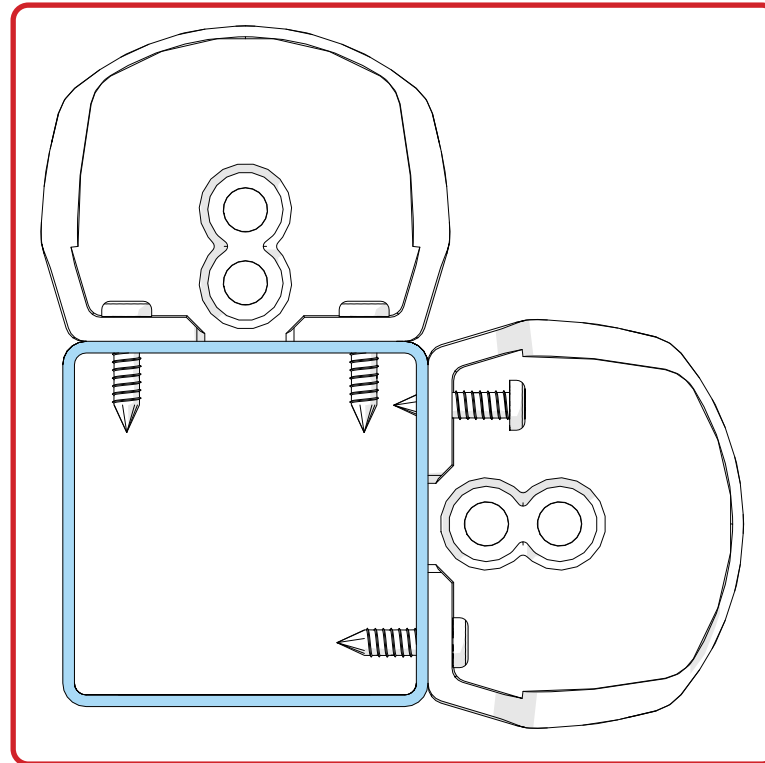

**Issue:** Screws appear to be clashing internally due to Universal Connectors fitting adjacent and at the same centre measurement.

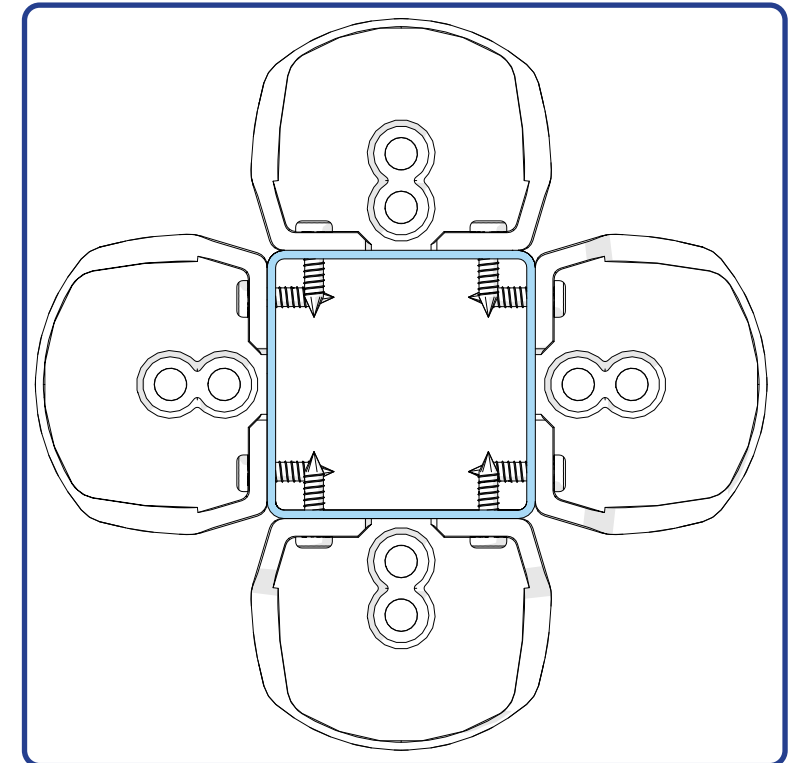

**Solution:** This is normal as per Kwiktech designs. Ensure self-drilling screws are pushed firmly and true in these situations and the self-drilling screw will naturally deflect past the previously fixed screw it clashes with.

# Cap Head Screw Jammed

## Trouble Shooting Guide

User Manual

Read in conjunction with  
Kwiktech Build Guide

Designed by



Rev 0

This Manual is the sole property of  
Kwiktech Pty Ltd.  
All rights are reserved.

This Manual is designed to be only  
used with Kwiktech  
produced products.

No part of this Manual or the  
Kwiktech product design may be  
copied or reproduced without the  
consent of Kwiktech Pty Ltd.

Construction using Kwiktech  
products may require planning  
approval. Always contact your Local  
Council for the most up-to-date  
rules and regulations for your area.

All dimensions are in millimeters  
(mm)

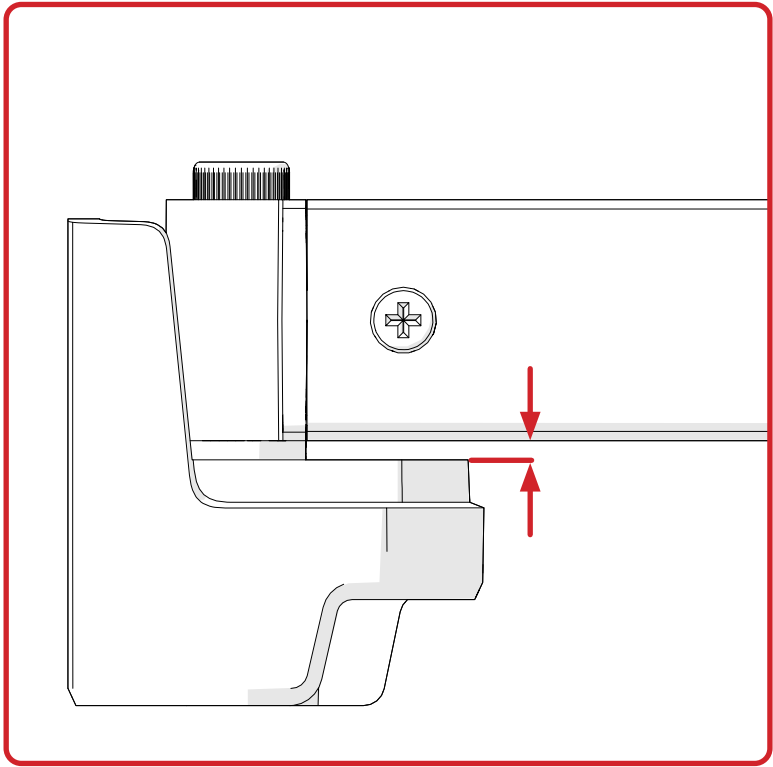

**Issue:** Cap Head Screw jammed within nut of  
Universal/Post Connector.

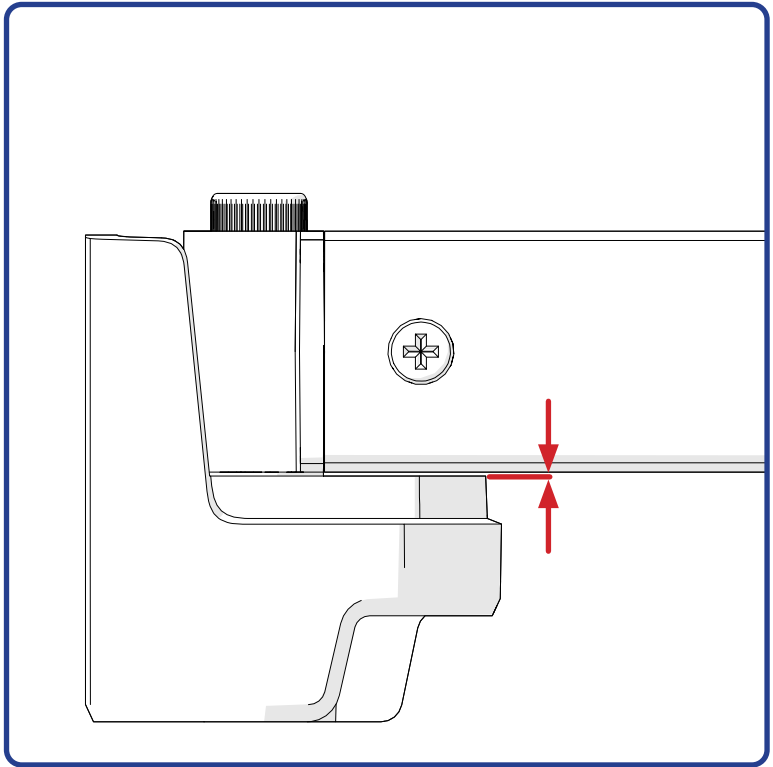

**Solution:** Ensure Rail Inserts are firmly placed into  
Universal/Post Connectors Before fixing with hex bit  
using an impact driver.

# Cladding Screw Alignment

## Trouble Shooting Guide

User Manual

Read in conjunction with  
Kwiktech Build Guide

Designed by

**kwiktech.**

Rev 0

This Manual is the sole property of  
Kwiktech Pty Ltd.  
All rights are reserved.

This Manual is designed to be only  
used with Kwiktech  
produced products.

No part of this Manual or the  
Kwiktech product design may be  
copied or reproduced without the  
consent of Kwiktech Pty Ltd.

Construction using Kwiktech  
products may require planning  
approval. Always contact your Local  
Council for the most up-to-date  
rules and regulations for your area.

All dimensions are in millimeters  
(mm)

[www.kwiktech.com.au](http://www.kwiktech.com.au)  
© Kwiktech Pty Ltd 2020

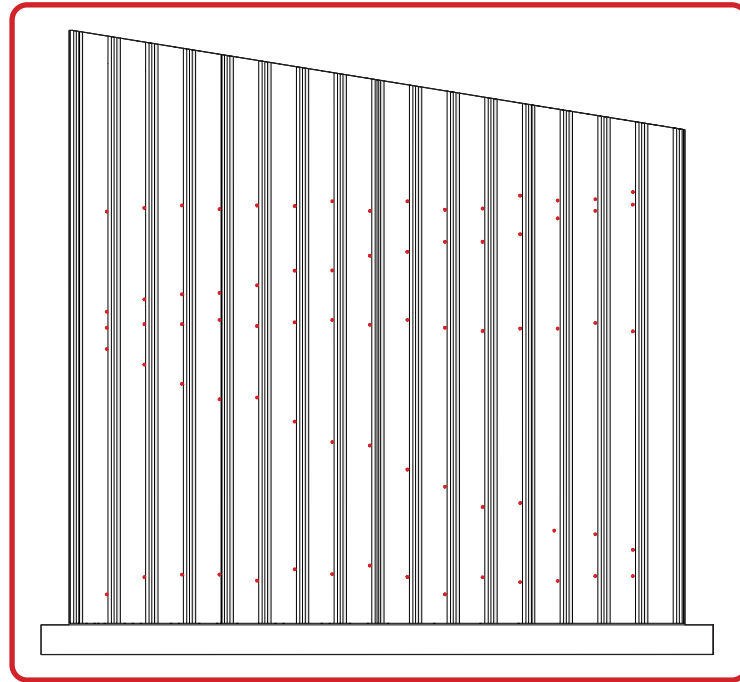

**Issue:** Cladding screws missing steel framework

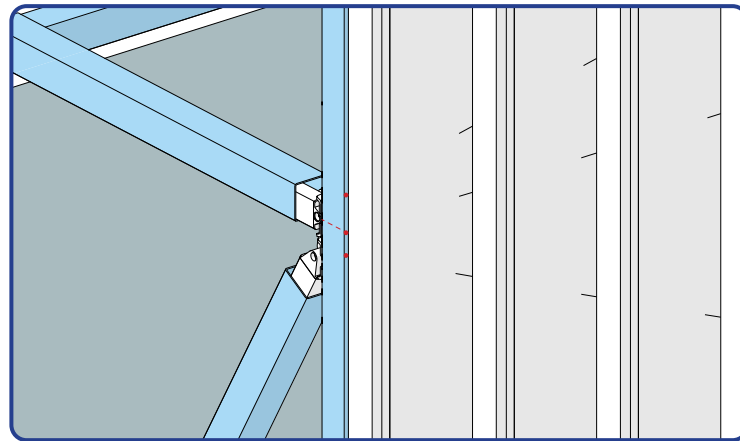

**Solution:** Hold cladding in place and use a straight edge to transfer centrelines onto the cladding. Mark a line before each rib for screw locations.

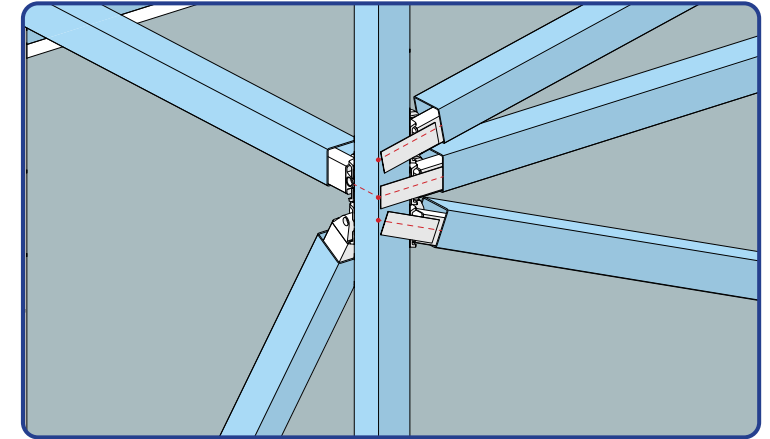

**Solution:** Mark the centerline of each diagonal & horizontal member on the corner of each vertical post member.

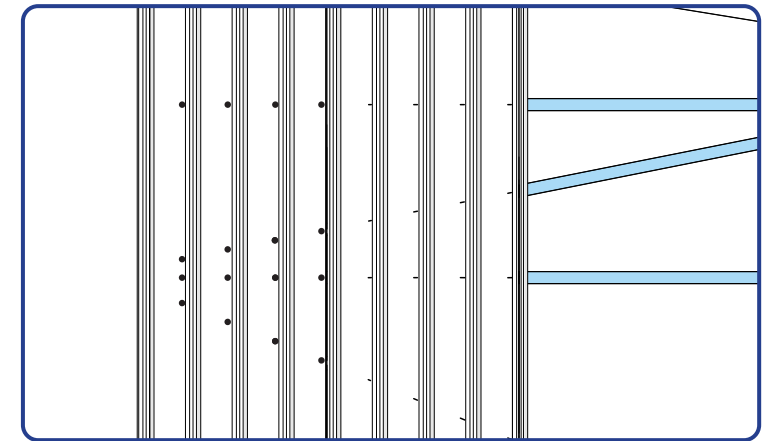

**Solution:** Repeat process with each section of cladding until finished.